

Tray-Mounted Installation

Package Contents

The pictures of the endpoint and accessories in this guide are for reference only. Please use the accessories in the package, and follow the guide for installation. Yealink assumes no responsibility for any damage caused by improper installation methods.

Tray Accessories



Tray

*65-inch and 86-inch tray are different in size and cannot be mixed.



Hook

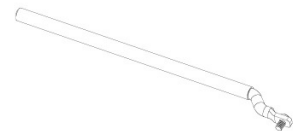

Plug X 2
(with M6x15 mm screw)



Screw X 4
(M5x10 mm)

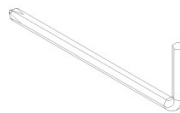

Hex key



Quick Start Guide

Endpoint Installation

NOTE

- About using a floor stand for installation, please refer to [Floor Stand-Mounted - Teams/Floor Stand-Mounted - Zoom](#).
- Install the tray after installing the floor stand.

CAUTION

Take and place all components gently to avoid damage.

1. Insert plugs into floor stand and fix them with screws



2. Install the tray by placing it on the plugs



3. Install hooks on both sides of the tray and fix them with screws

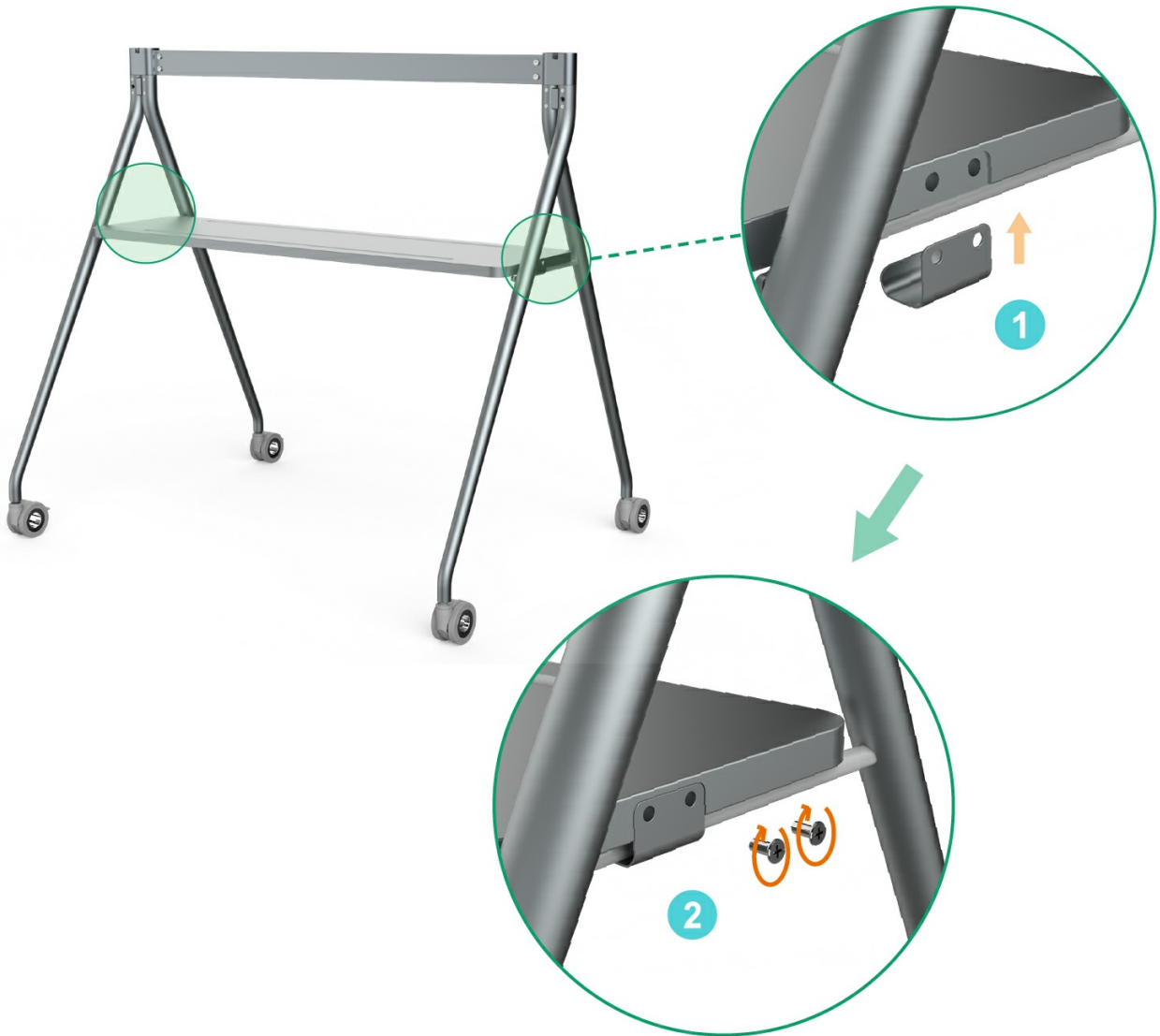
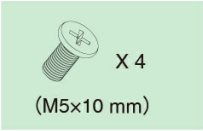

After installing the deployment, you can refer to [Quick Setup - Teams](#) / [Quick Setup - Zoom](#) to set up the MeetingBoard. After setup, please refer to [Quick Usage - Teams](#) / [Quick Usage - Zoom](#) to learn about general functions.